

POWER DISTRIBUTION MANAGER

Mounting Hardware Instruction



Model Numbers:

TTPDM-BRKTBASE,
TTPDM-BRKTSTACK,

TOWA Tools PDM Base Bracket
TOWA Tools PDM Stacking Bracket

Ver 12.5.22

BASE BRACKET INSTRUCTION:

Kit includes:

Fasteners, qty-2
(8-32 x ¼ Phil Flat Head)

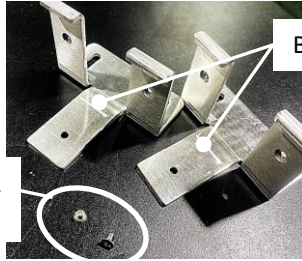

NOTE: INSTALL ALL SCREWS USING
STANDARD RED THREADLOCK
(NOT INCLUDED)

Installation:

To install, slide bracket onto each side of enclosure, align clearance hole in bracket to threaded hole on underside of PDM (view below left and center). Apply thread-lock to thread of supplied Philips screw and securely install screw to bracket through the clearance hole shown in (2) of the middle figure below. Ensure screw is fully seated into bracket. Flip unit right side up, when installed correctly it should appear as shown in view below on the right. Secure to surface using suitable fasteners (not supplied) installed through the slotted holes at the base of the bracket.

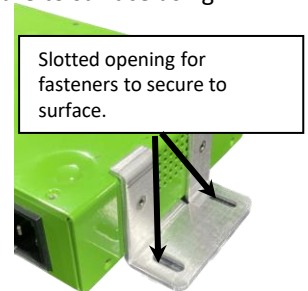
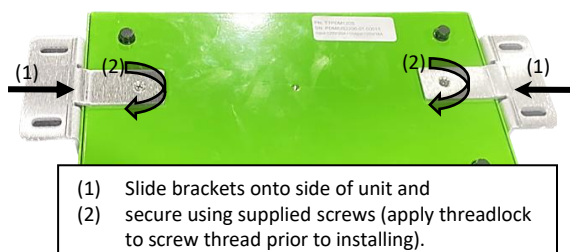
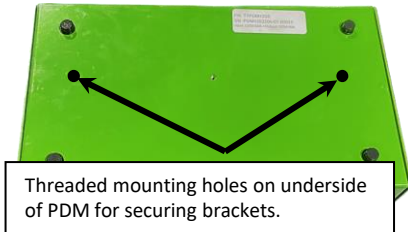

STACKING BRACKET INSTRUCTION:

NOTE: INSTALL ALL SCREWS
USING STANDARD RED
THREADLOCK (NOT INCLUDED)

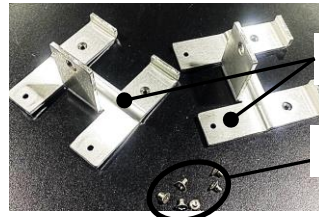

Stacking Brackets, qty-2

Fasteners, qty-6 (8-32 x ¼ Phil Flat Head)

Installation:

To install, slide on and secure stacking bracket similarly as to what was done for the base bracket above (below view left, ensure bolt is secured using threadlock and fully seated). Flip unit right side up and slide down upon previously secured base unit, tabs between brackets will slide over each other. Install screws at location indicated on at both ends and tighten as needed. Additional PDMs are added in a similar fashion.

